

**D-80S    80x80x220cm**

**D-90S    90x90x220cm**

**D-10S    100x100x220cm**

**D-80    80x80x208cm**

**D-90    90x90x208cm**

**D-10    100x100x208cm**

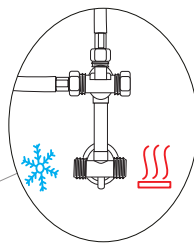
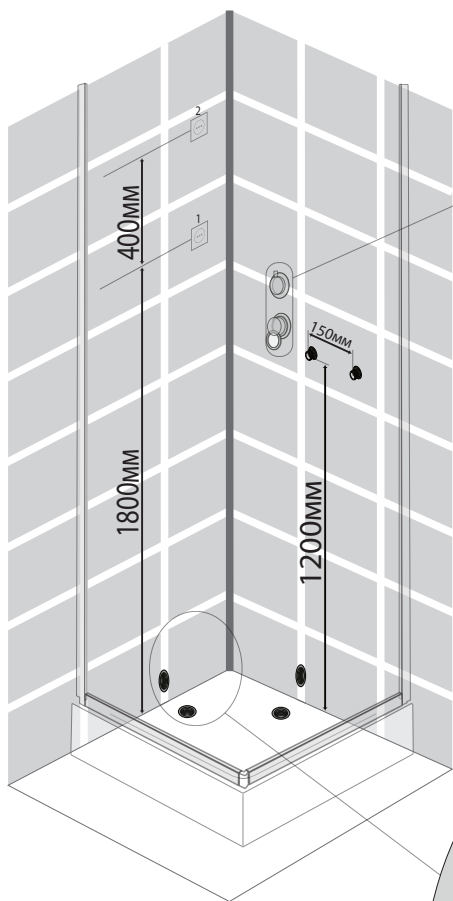

1 Розетка с заземлением для кабин с комплектацией парогенератора

2 Розетка с заземлением для кабин с электрикой и LED-подсветкой



Вывод канализации устанавливается в уровень с полом из стены или из пола под срез кафельной плитки

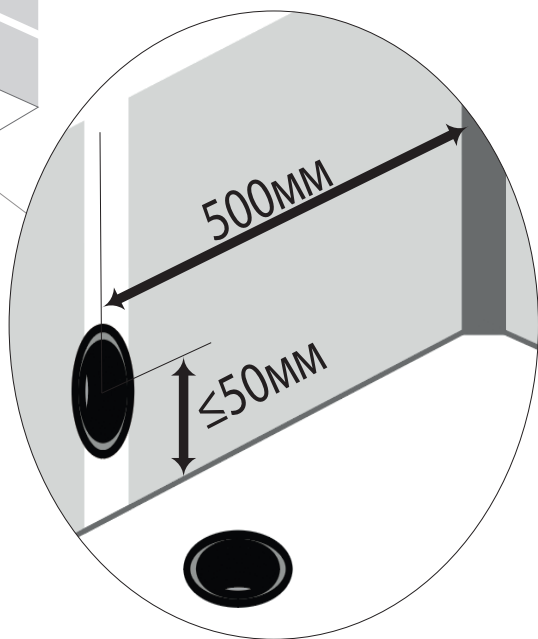

✓ Если высота канализации не позволяет вывести на данную высоту вывод, то изготавливается подиум, повторяющий форму кабины (бокса, ванны) с допуском по периметру приблизительно плюс 5см. Высота подиума зависит от высоты вывода канализации.

✓ Подиум, также как и пол под ванной должен быть выложен плиткой.

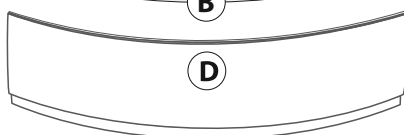
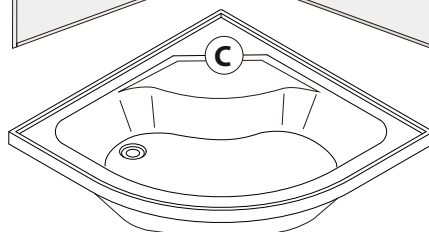
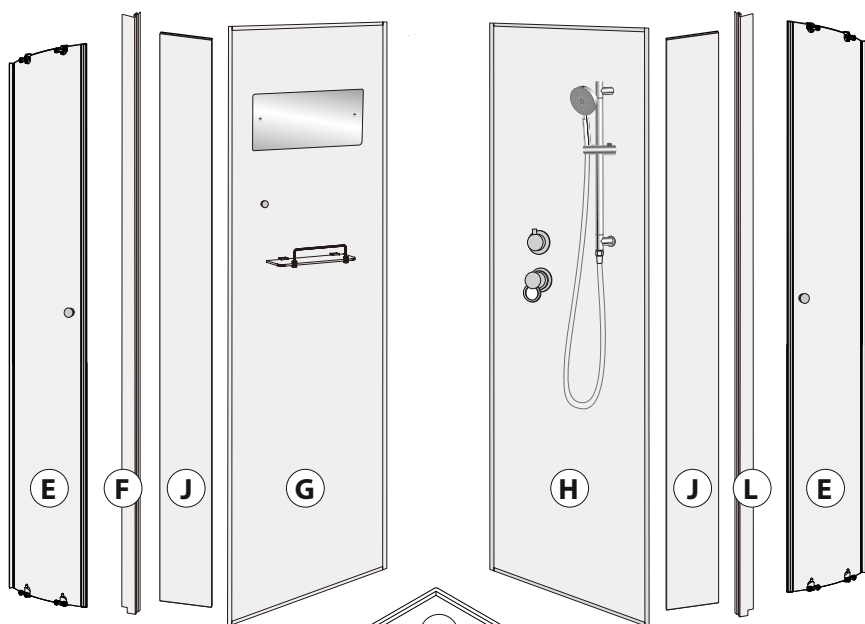
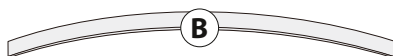
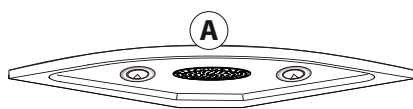

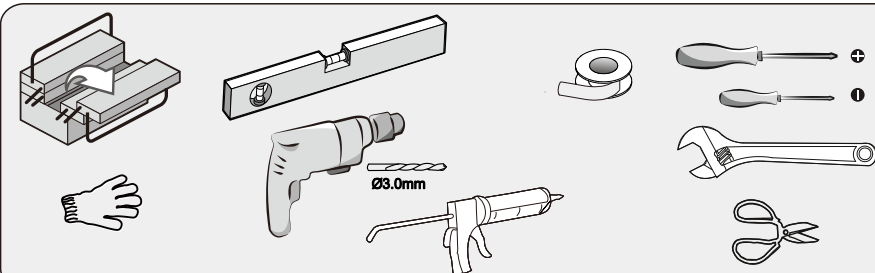
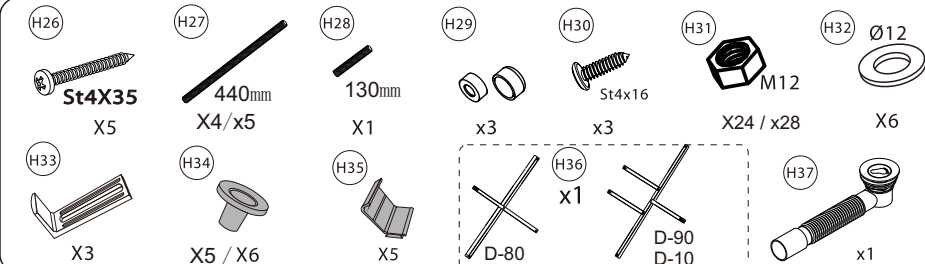
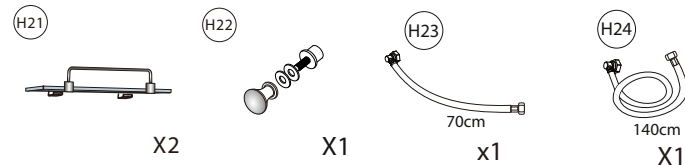
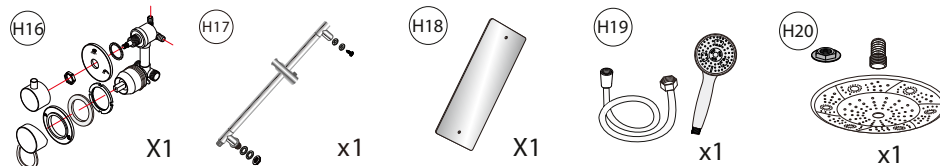
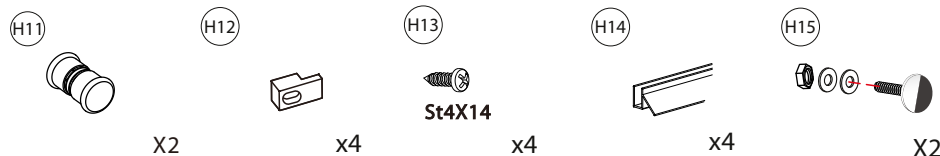
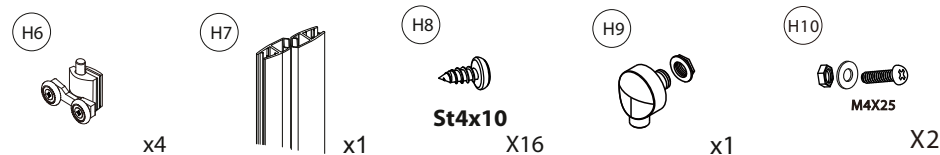
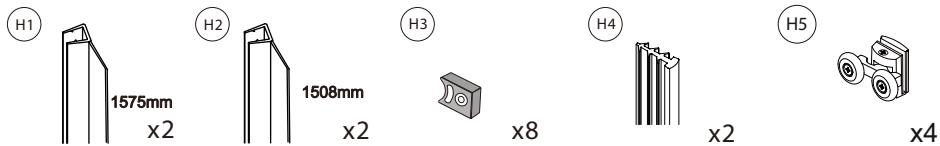
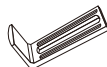
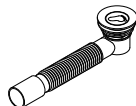
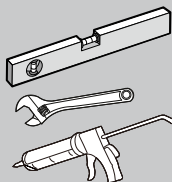
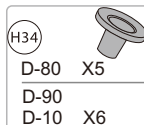
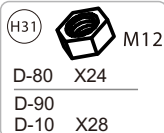
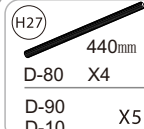
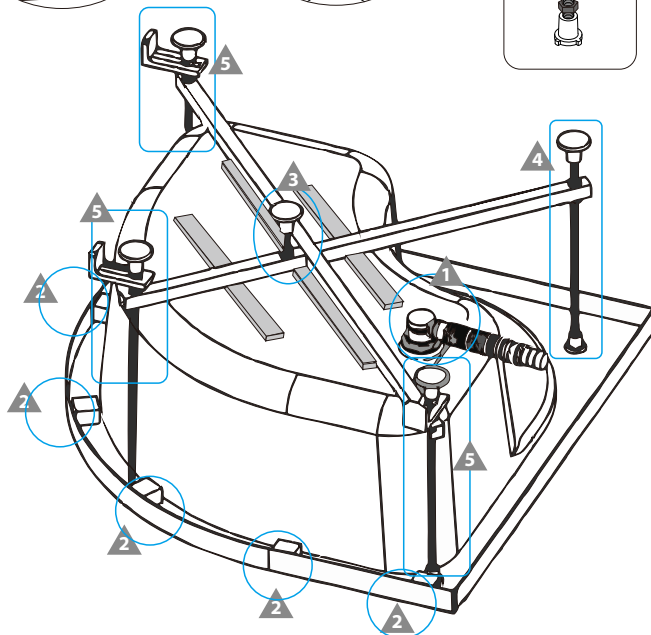
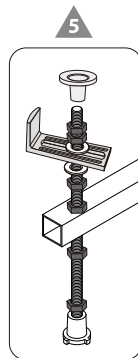
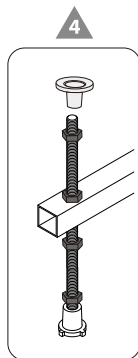
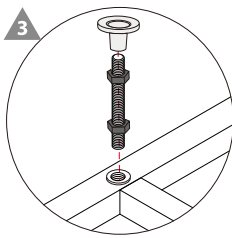
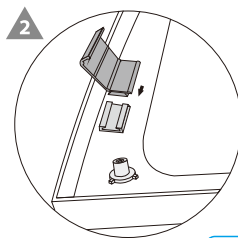

Diagram illustrating the assembly of the H37 sensor into the control unit. The process involves inserting the sensor into the unit and securing it with a screw.



© x1

(H36) x1

(H37) x1

(H35) x5

(H33) X3

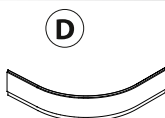
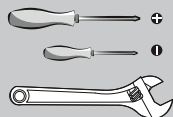
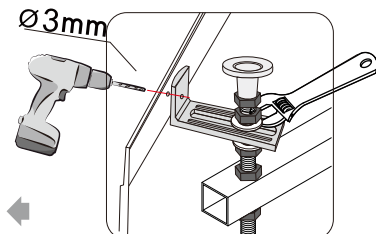
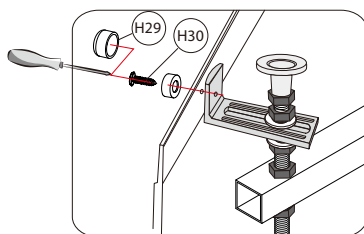
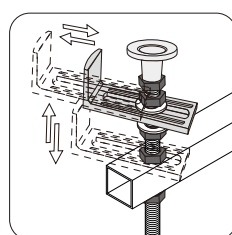
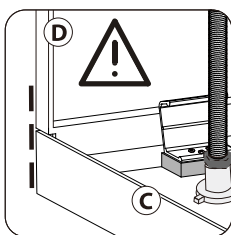
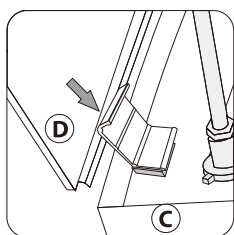
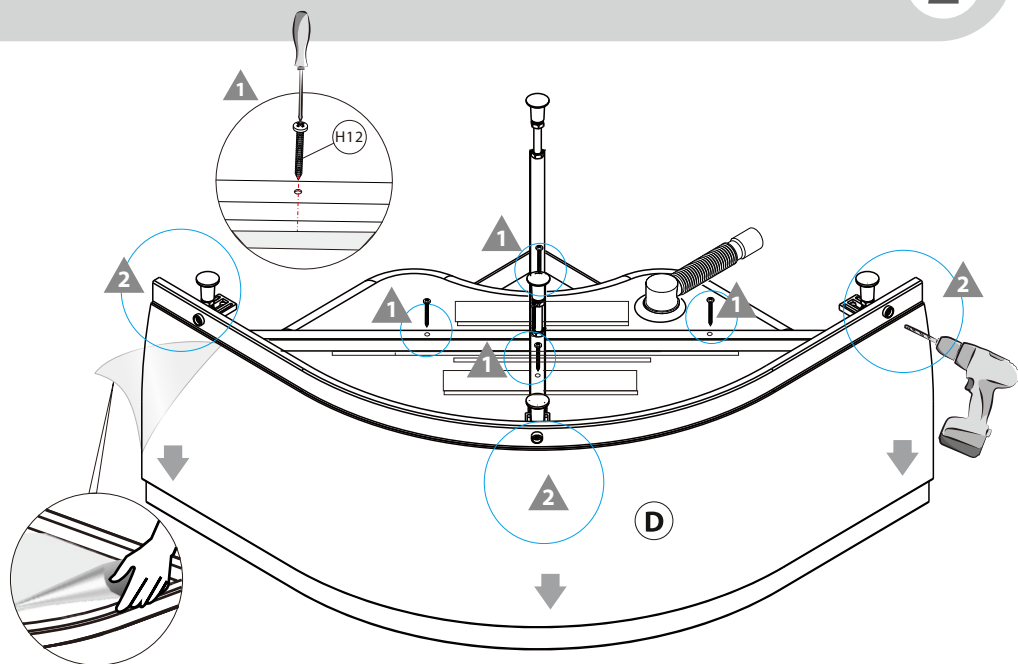

x1

H26



St4X35

X5

H29



x3

H30



St4x16

x3

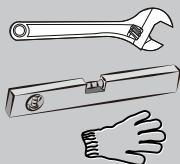
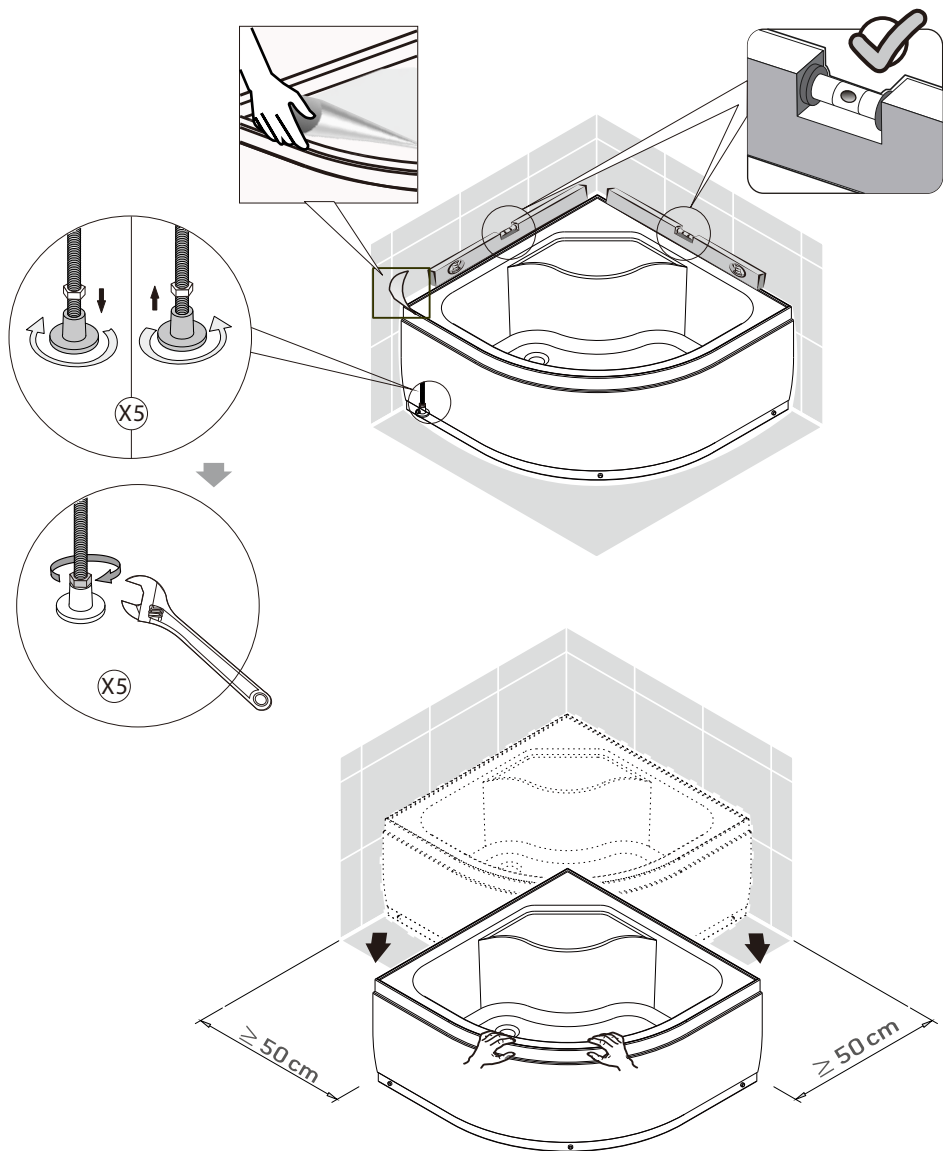

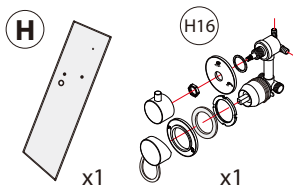
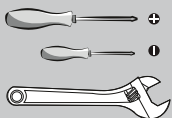
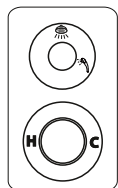
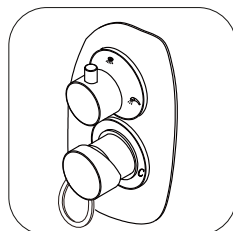
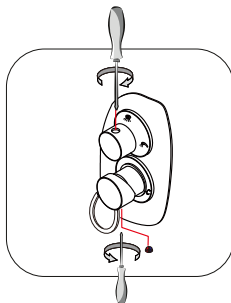
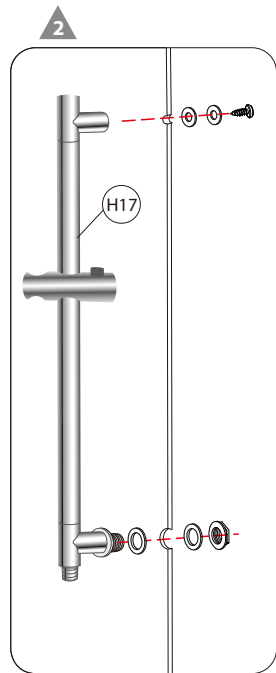
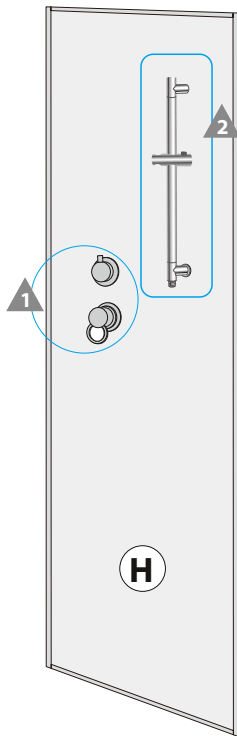
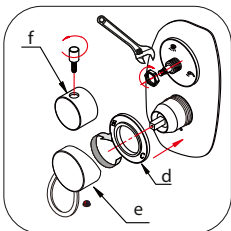
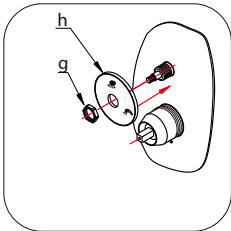
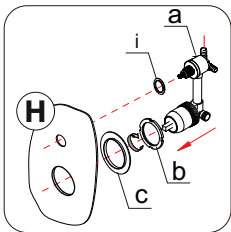



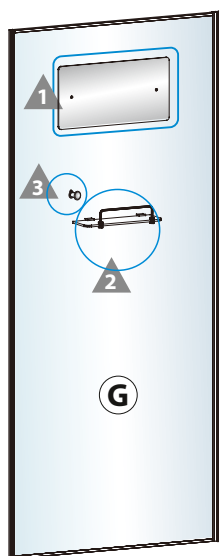
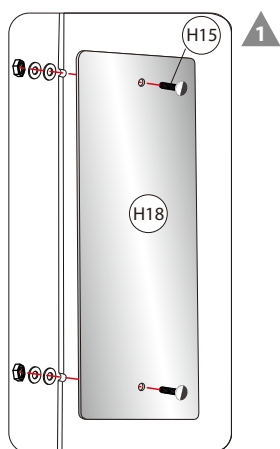

or

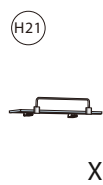
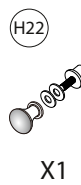
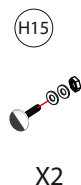
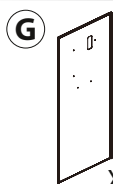
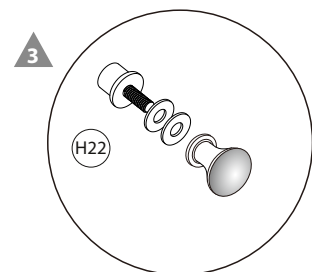
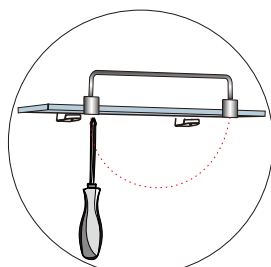
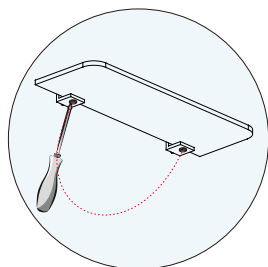
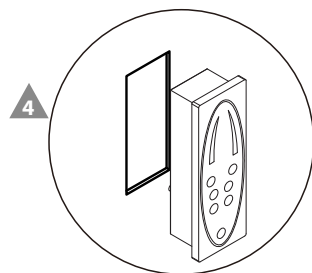
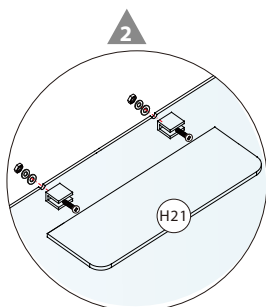
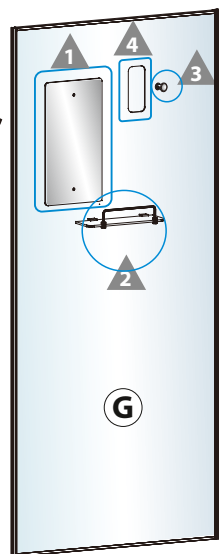

G

H18

H15

H22

H21

X1

X1

X2

X1

X1

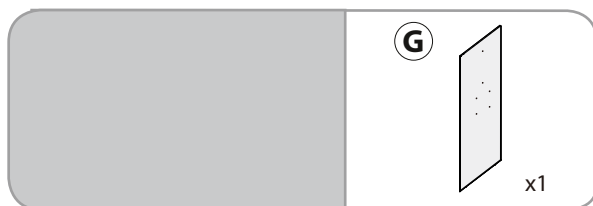
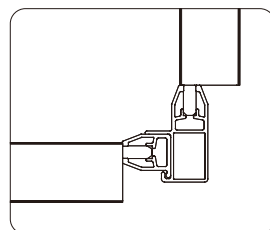
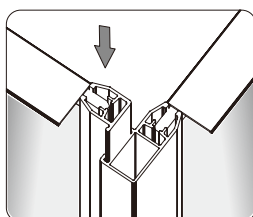
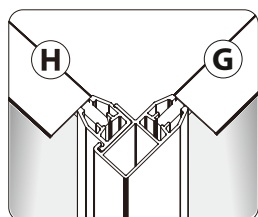
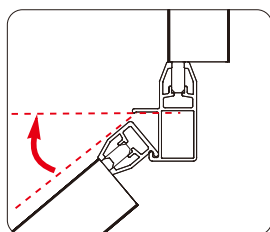
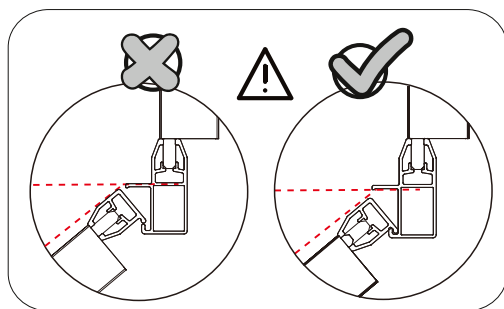
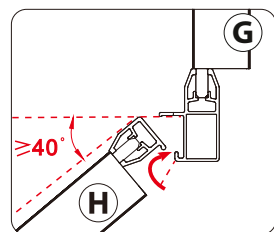
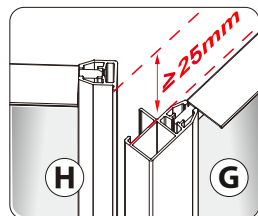
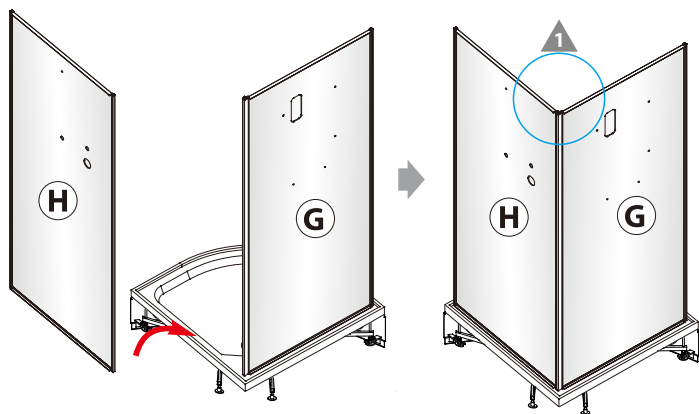

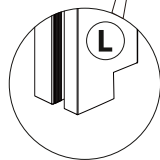
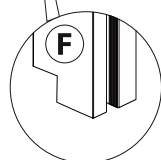
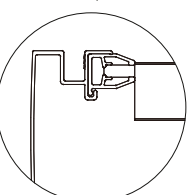
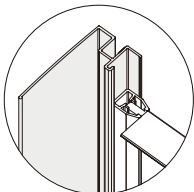
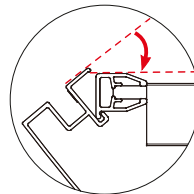
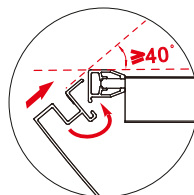
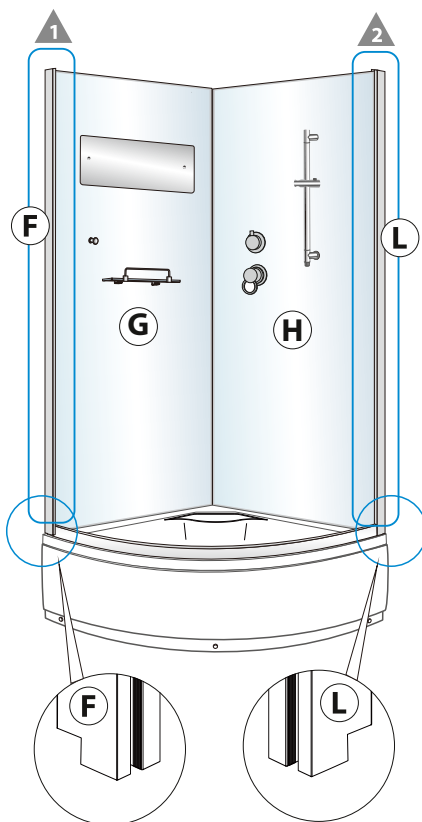
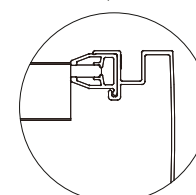
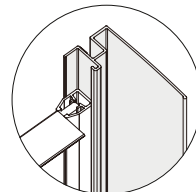
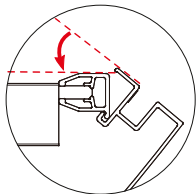
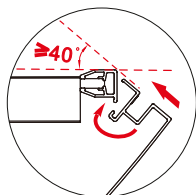
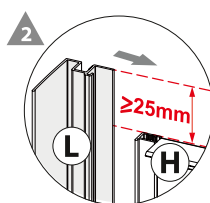
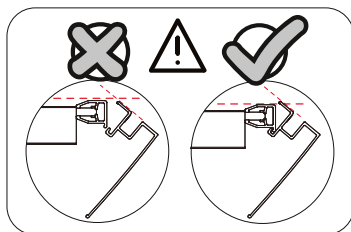
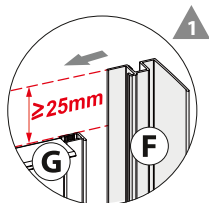

F



x1

L



x1

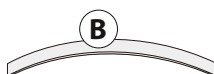
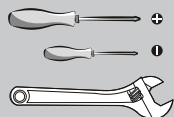
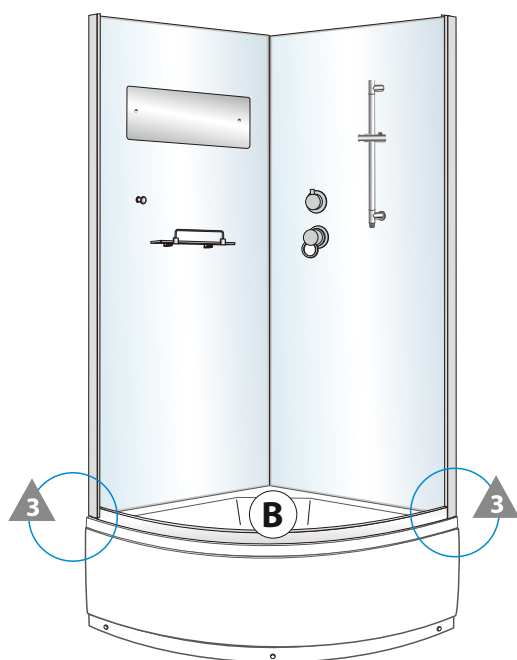
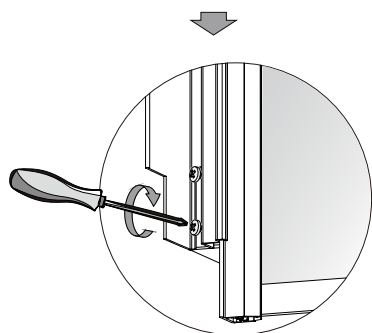
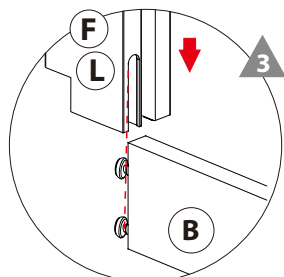
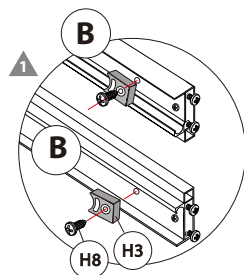
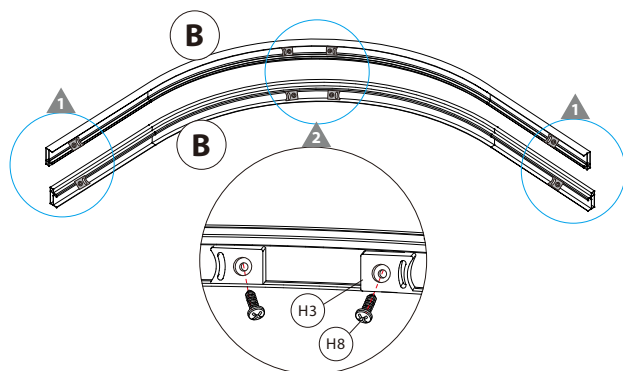

B

X2

H3



X8

H8



ST4X10

X8

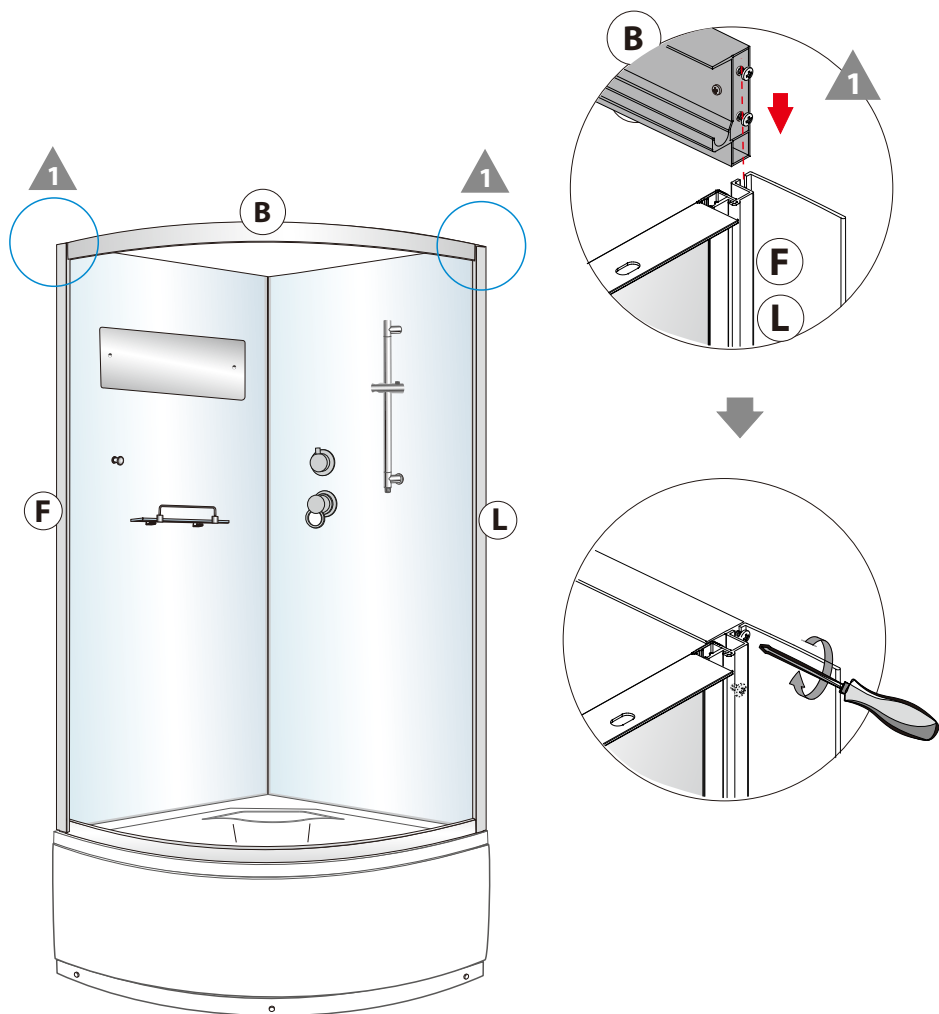

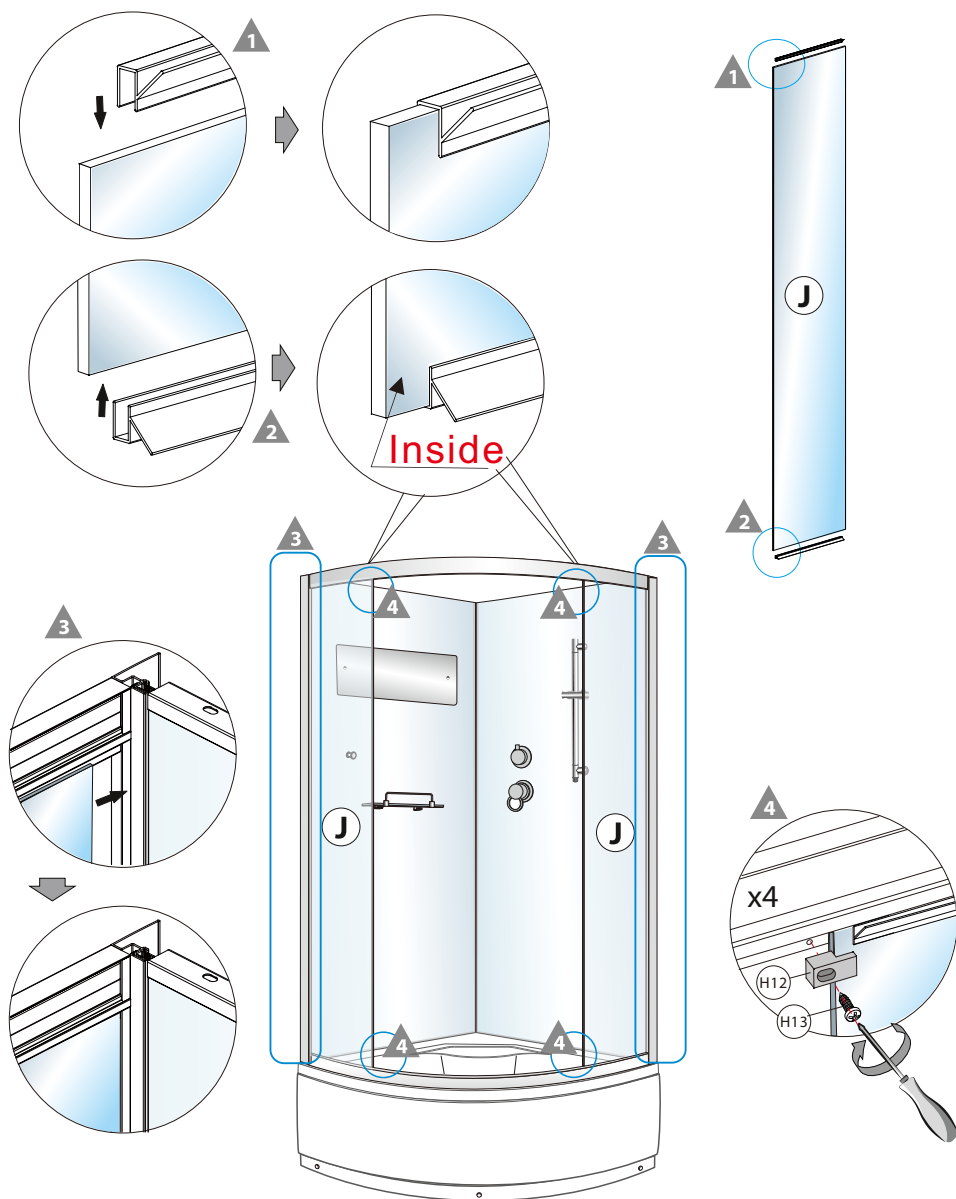

J



x2

H14



x4

H12



x4

H13



St4X14

x4

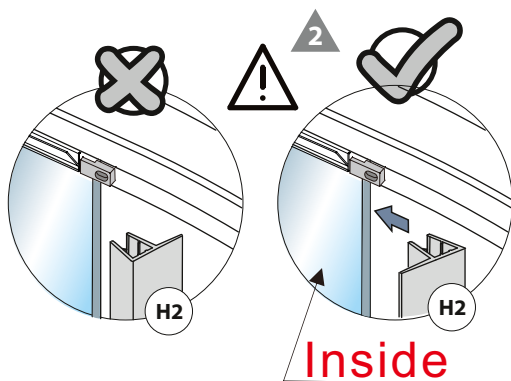
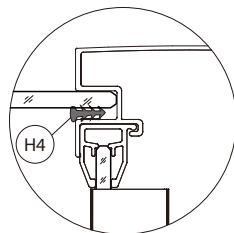
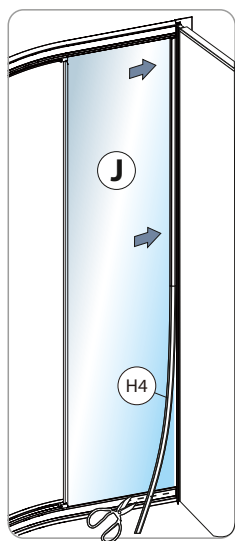
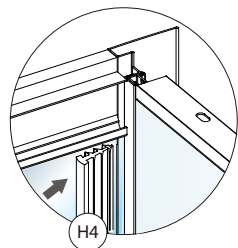
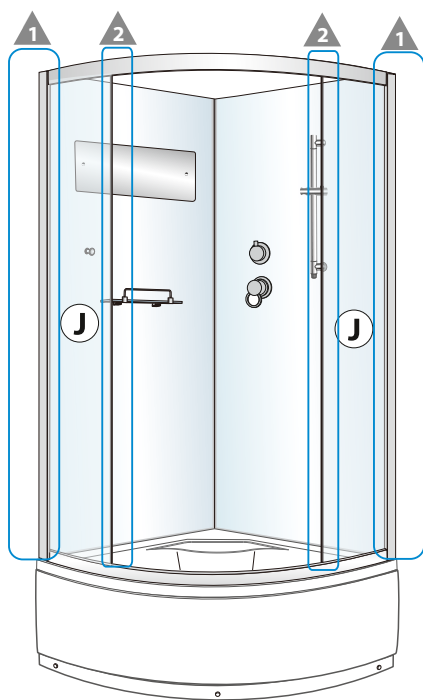

H4



X2

H2



X2

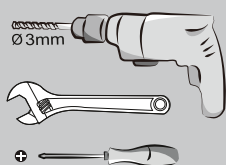
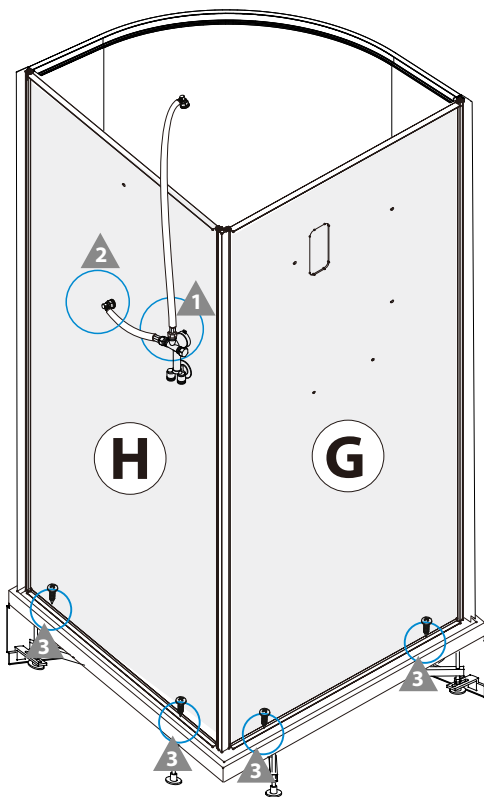
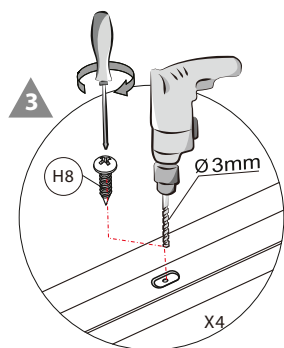
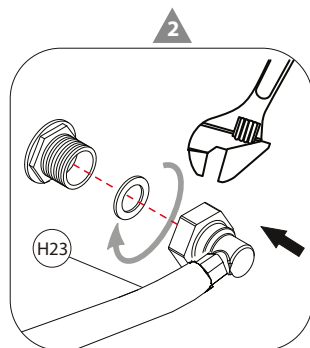
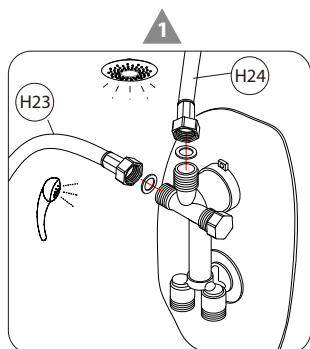

x4

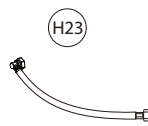

x1



X1



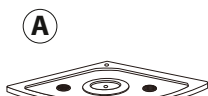
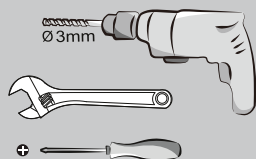
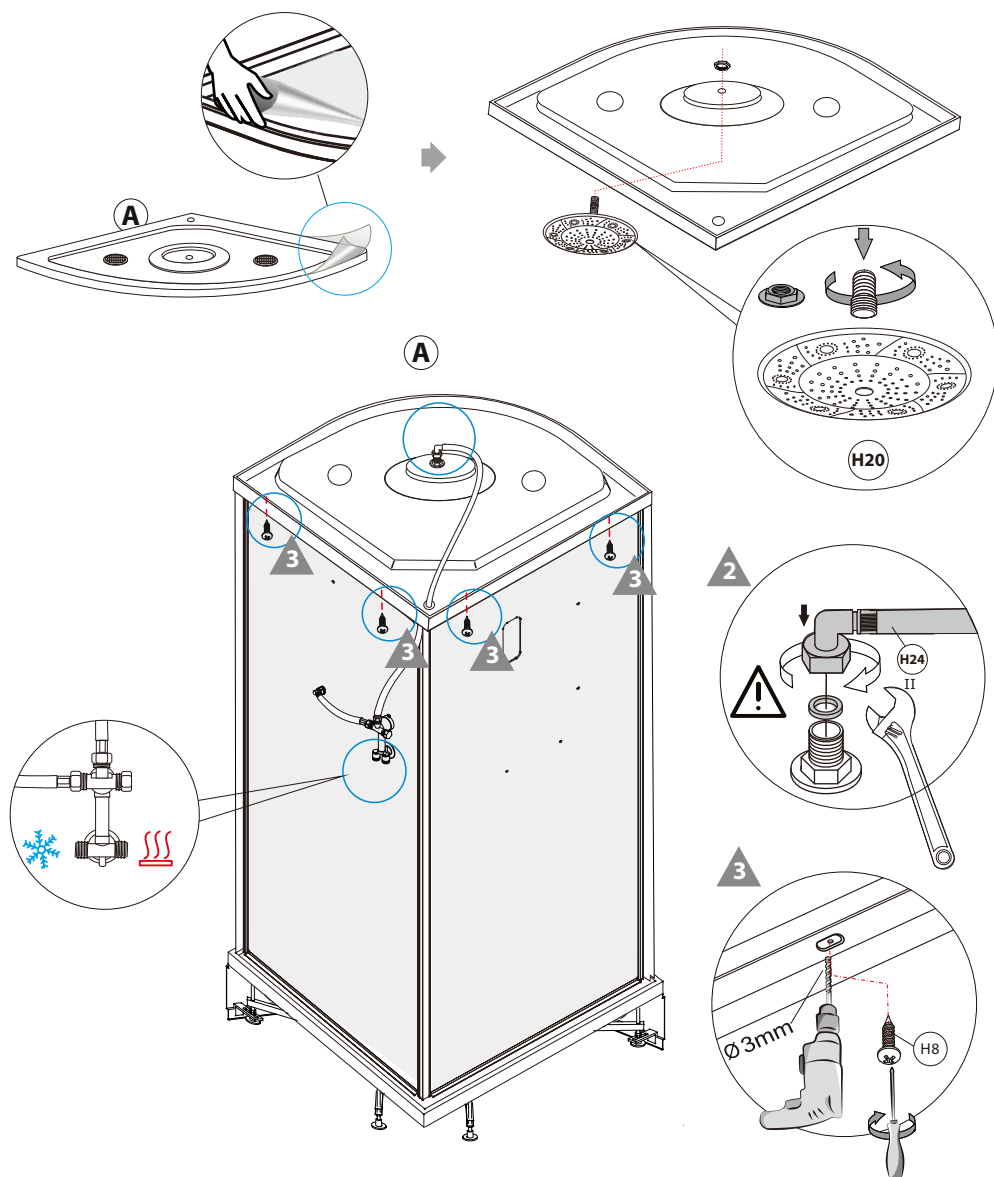

x1



x1

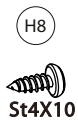

St4X10

X4

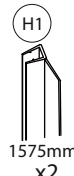
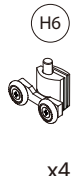
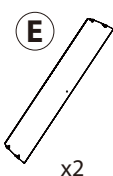
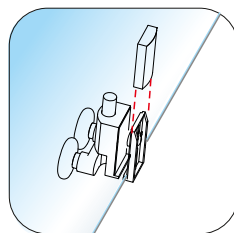
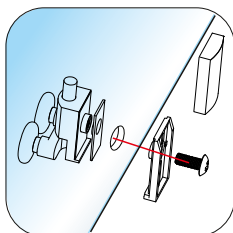
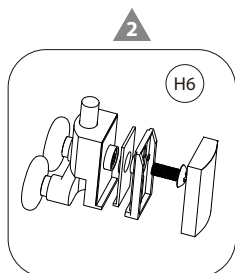
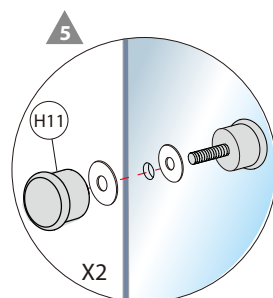
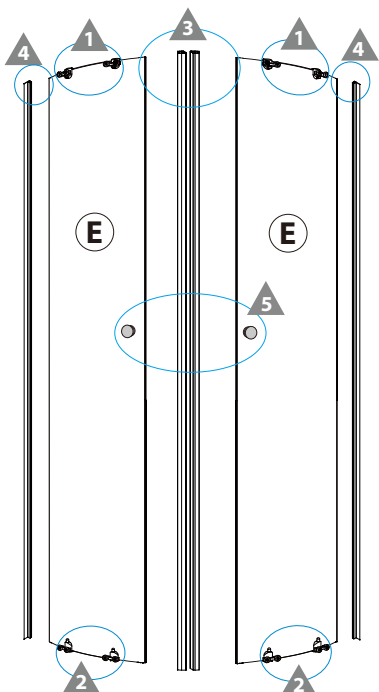
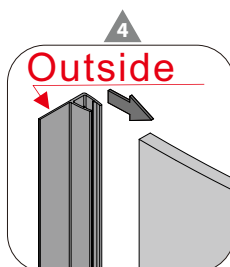
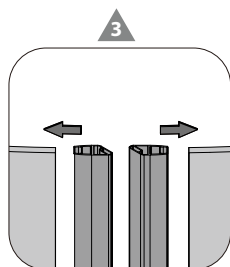
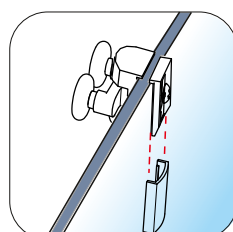
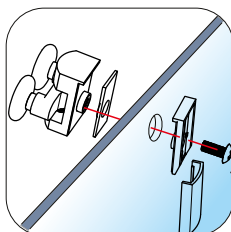
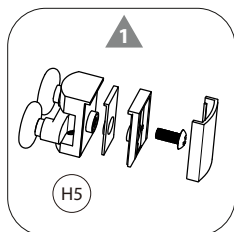

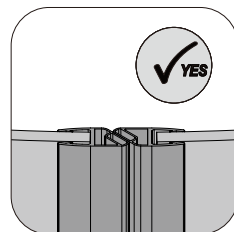
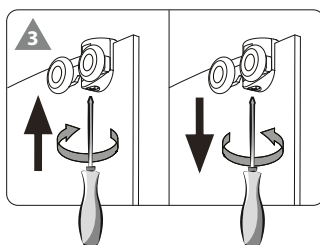
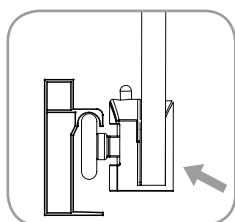
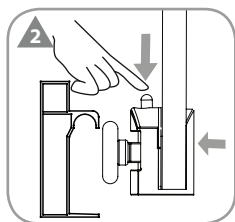
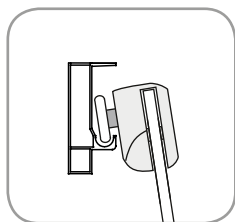
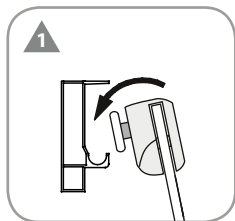

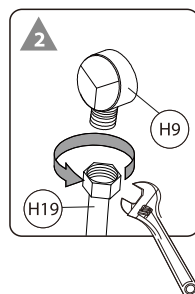
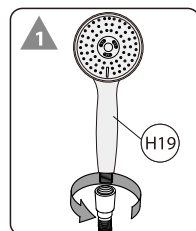
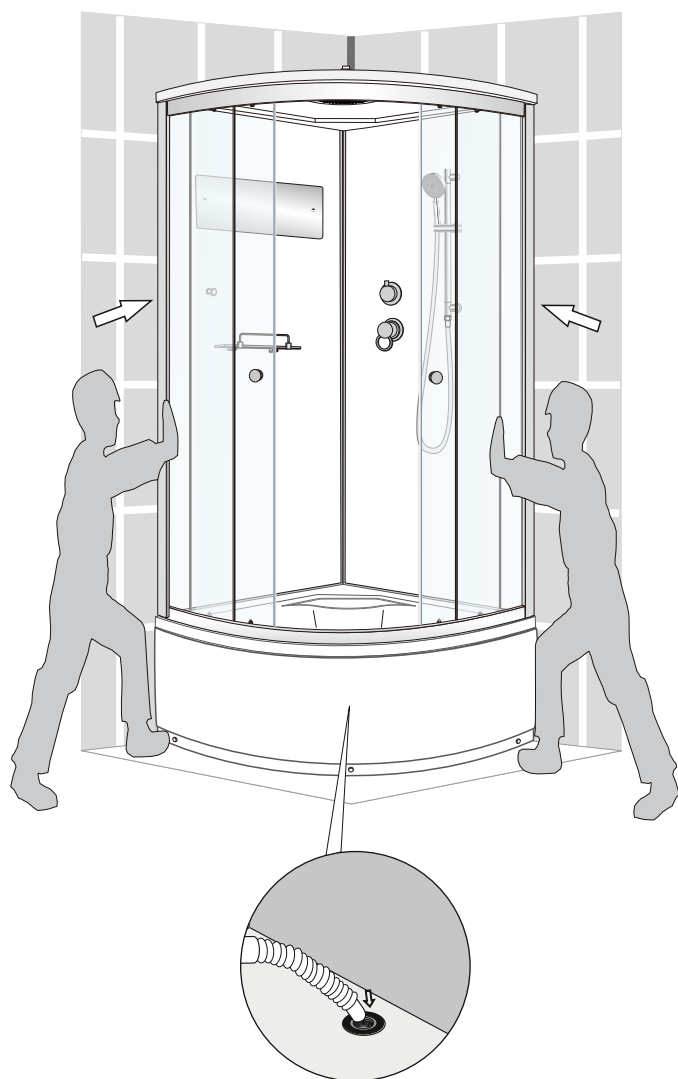

H19



x1